



Technical Catalogue

System Climate Control



250k sq ft.
PRODUCTION AREA



15million
MOTORS/YEAR



200+
POINT OF SALES



EXPORT TO
20+
COUNTRIES



1000+
CUSTOMERS



Performance with Purpose

Founded in 1988, Hicool is a leading manufacturer of motors, fans and blowers serving diverse markets and covering the entire scope of air moving technology and thermal solutions.

Our highly skilled team are driven every single day to create tailor-made solutions for complex applications in different industries. Our engineers are passionate about working very closely with our customers to meet their exact requirements in the most cost-effective way.

By having full control of our process chain, we are able to deliver unrivalled quality products with superior lifespans and reliability.

Hicool products enhance operational efficiency, save energy and improve customer product and equipment lifetime by providing the desired amount of temperature control.

With three state of the art manufacturing facilities and a yearly capacity of over 15 million motors we are able to cater to the rising demand of climate and temperature control products.

Do contact us for tailor-made solutions for your needs.





Compact Fans - AC

Compact Fans - AC



Model	Bearing	Voltage (VAC)	Frequency (Hz)	Current (A)	Speed (RPM)	Power (W)	Air Flow (CFM)	Static Pressure (mm H ₂ O)	Noise (dBA)	Wt. kg
-------	---------	---------------	----------------	-------------	-------------	-----------	----------------	---------------------------------------	-------------	--------

80X80X25mm (Pack size: 50 No's)

8A115HBAC	Ball	115	50/60	0.210/0.180	2300/2800	14/12	21/25	4/4.8	29/34	12
8A115HSAC	Sleeve	115	50/60	0.210/0.180	2300/2800	14/12	21/25	4/4.8	29/34	12
8A230HBAC	Ball	230	50/60	0.070/0.060	2300/2800	14/12	21/25	4/4.8	29/34	12
8A230HSAC	Sleeve	230	50/60	0.070/0.060	2300/2800	14/12	21/25	4/4.8	29/34	12

92X92X25mm (Pack size: 50 No's)

9A115HBAC	Ball	115	50/60	0.210/0.180	2300/2800	14/14	36/42	5/6	36/38	15
9A115HSAC	Sleeve	115	50/60	0.210/0.180	2300/2800	14/14	36/42	5/6	36/38	15
9A230HBAC	Ball	230	50/60	0.070/0.060	2300/2800	14/12	36/42	5/6	36/38	15
9A230HSAC	Sleeve	230	50/60	0.070/0.060	2300/2800	14/12	36/42	5/6	36/38	15

120X120X38mm (Pack size: 40 No's)

12A24HBAC	Ball	24	50/60	1/0.9	2650/2800	18/17	95/102	8.4/9.4	43/46	20
12A24HSAC	Sleeve	24	50/60	1/0.9	2650/2800	18/17	95/102	8.4/9.4	43/46	20
12A115HBAC	Ball	115	50/60	0.200/0.180	2650/2800	14/12	95/102	8.4/9.4	43/46	20
12A115HSAC	Sleeve	115	50/60	0.200/0.180	2650/2800	14/12	95/102	8.4/9.4	43/46	20
12A230HBAC	Ball	230	50/60	0.100/0.090	2650/2800	18/17	95/102	8.4/9.4	43/46	20

Note:

- Weight mentioned is for the pack size.
- Ask for Low Noise versions

Specifications subject to change without notice

Compact Fans - AC



Model	Bearing	Voltage (VAC)	Frequency (Hz)	Current (A)	Speed (RPM)	Power (W)	Air Flow (CFM)	Static Pressure (mm H ₂ O)	Noise (dBA)	Wt. kg
-------	---------	---------------	----------------	-------------	-------------	-----------	----------------	---------------------------------------	-------------	--------

12A230HSAC	Sleeve	230	50/60	0.100/0.090	2650/2800	18/17	95/102	8.4/9.4	43/46	20
12A415HBAC	Ball	415	50/60	0.070/0.060	2650/2800	20/20	95/102	8.4/9.4	43/46	20
12A415HSAC	Sleeve	415	50/60	0.070/0.060	2650/2800	20/20	95/102	8.4/9.4	43/46	20

172 Φ x150x51mm & 172x172x55mm (Pack size: 20 No's)

17A115HBAC	Ball	115	50/60	0.450/0.450	2600/2750	41/38	190/235	16/21	52/55	20
17A115HSAC	Sleeve	115	50/60	0.450/0.450	2600/2750	41/38	190/235	16/21	52/55	20
17A230HBAC	Ball	230	50/60	0.250/0.245	2600/2750	38/37	190/235	16/21	52/55	20
17A230HSAC	Sleeve	230	50/60	0.250/0.245	2600/2750	38/37	190/235	16/21	52/55	20
17A415HBAC	Ball	415	50/60	0.125/0.125	2600/2750	38/38	190/235	16/21	52/55	20
17A415HSAC	Sleeve	415	50/60	0.125/0.125	2600/2750	38/38	190/235	16/21	52/55	20

220 Φ X60mm & 220X220X60mm (Pack size: 10 No's)

22A115HBAC	Ball	115	50	0.640	2300	50	360	23	56	16
22A115HSAC	Sleeve	115	50	0.640	2300	50	360	23	56	16
22A115HBAC-X	Ball	115	50	0.650	2600	55	430	28	56	16

Note:

- Weight mentioned is for the pack size.
- Ask for Low Noise versions
- 17A and 22A models available in square and round casings

Specifications subject to change without notice

Compact Fans - AC



Model	Bearing	Voltage (VAC)	Frequency (Hz)	Current (A)	Speed (RPM)	Power (W)	Air Flow (CFM)	Static Pressure (mm H ₂ O)	Noise (dBA)	Wt. kg
22A115HBAC-X-6H	Ball	115	60	0.700	2600	55	430	28	56	16
22A230HBAC	Ball	230	50	0.320	2300	50	360	23	56	16
22A230HSAC	Sleeve	230	50	0.320	2300	50	360	23	56	16
22A230HSAC-X	Sleeve	230	50	0.32	2600	55	430	28	56	16
22A230HSAC-X-6H	Sleeve	230	60	0.40	2700	60	450	29	57	16
22A230HBAC-X	Ball	230	50	0.32	2600	55	430	28	56	16
22A230HBAC-X-6H	Ball	230	60	0.40	2700	60	450	29	57	16
22A415HBAC	Ball	415	50	0.200	2300	50	360	23	56	16
22A415HSAC	Sleeve	415	50	0.200	2300	50	360	23	56	16
22A415HSAC-X	Sleeve	415	50	0.160	2600	50	430	28	56	16
22A415HBAC-X	Ball	415	50	0.160	2600	50	430	28	56	16

Note:

- Weight mentioned is for the pack size.
- Ask for Low Noise versions
- 17A and 22A models available in square and round casings

Specifications subject to change without notice

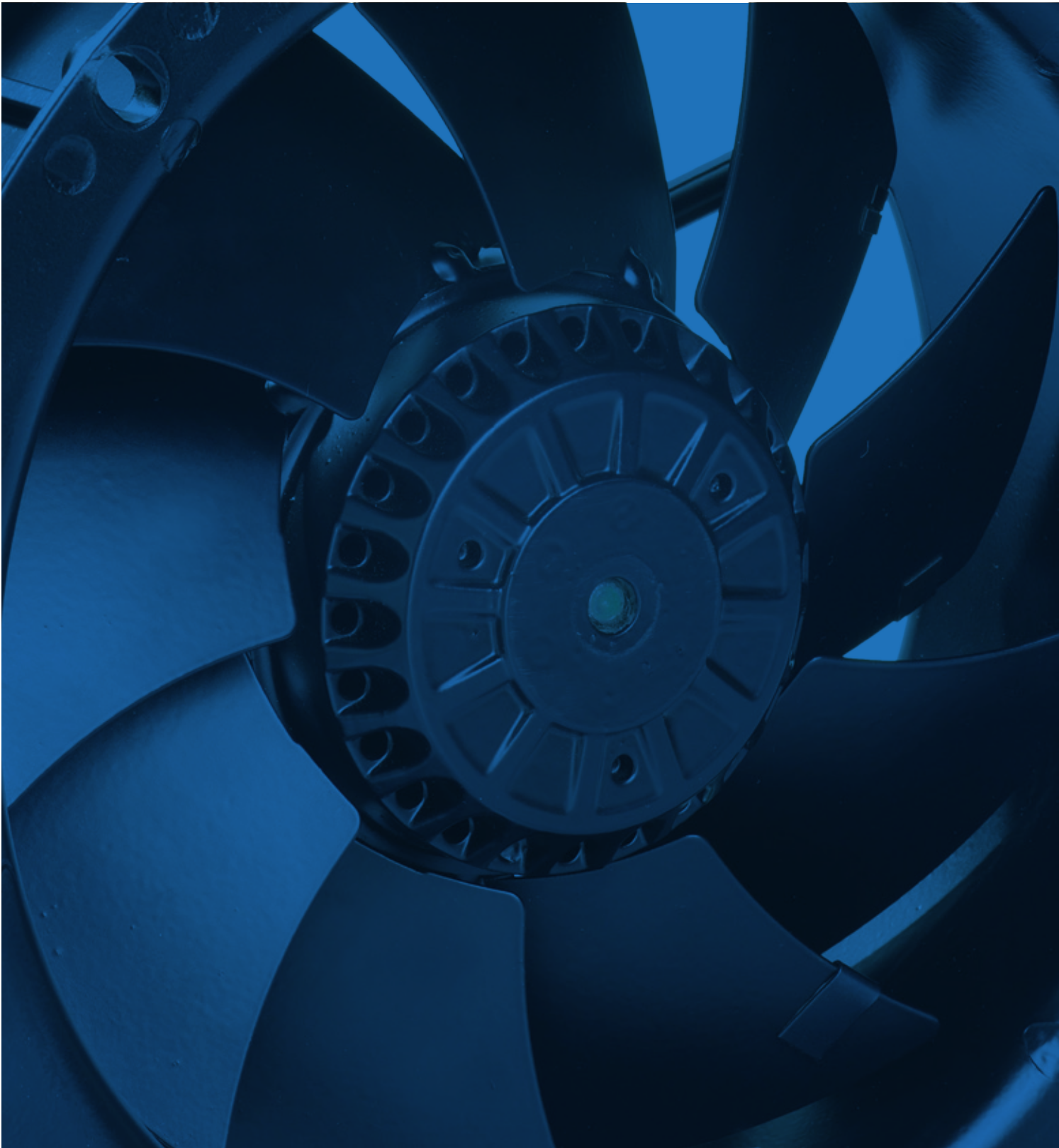

Compact Fans - All Metal

Compact Fans - All Metal



AC Axial

Model	Bearing	Voltage (VAC)	Frequency (Hz)	Current (mA)	Speed (RPM)	Power (W)	Air Flow (CFM)	Static Pressure (mm H ₂ O)	Noise (dBA)	Wt. kg
120 x 120 x 38 mm - Metal (Pack size: 20 No's)										
12A230HBAC-M	Ball	230	50/60	100/90	2700/3100	17/15	95/107	8.4/9.4	42/46	12
172 x 150 x 55 mm - Metal (Pack size: 10 No's)										
17A230HBAC-M	Ball	230	50/60	250/230	2800/3250	42/42	195/230	14/16	49/53	12
225 x 225 x 80 mm - Metal (Pack size: 8 No's)										
225A230HBAC-M	Ball	230	50/60	300/325	2500/2800	65/70	530/600	17/14	59/61	20
225A230HBAC-M-J	Ball	230	50	420	2750	82	600	18.7	60	20
280 x 280 x 80 mm - Metal (Pack size: 6 No's)										
280A230HBAC-M	Ball	230	50/60	590/820	2500/2700	119/130	1090/1130	16.5/20	68/70	21

Also available 115VAC & 415VAC

DC Brushless

Model	Bearing	Voltage (VDC)	Current (mA)	Speed (RPM)	Power (W)	Air Flow (CFM)	Static Pressure (mm H ₂ O)	Noise (dBA)	Wt. kg
225 x 225 x 80 mm - Metal (Pack size: 6 No's)									
225A48HBDC - M	Ball	48	1100	2850	52.8	647	25	67	20
280 x 280 x 80 mm - Metal (Pack size: 6 No's)									
280A48HBDC - M	Ball	48	1900	2700	91.2	1130	22	69	21

Note:

■ Weight mentioned is for the pack size.

Specifications subject to change without notice



Backward Curved Fans

Backward Curved Fans



Model	Size mm	Phase	Voltage (VAC)	Frequency (Hz)	Current (A)	Power (W)	Speed (RPM)	Airflow (M³/hr)	Noise dBA	Cap µf/450V	wt Kg	Pack Size
BCF-175	Φ175 x 62	Single	230	50/60	0.39/0.34	61/62	2350/2200	440/470	59/62	2	11	8
BCF-190	Φ192 x 63	Single	230	50/60	0.39/0.48	65/68	2400/2600	570/630	62/65	2	14	8
BCF-220	Φ220 x 63	Single	230	50/60	0.4/0.5	110/120	2500/2600	800/865	65/68	3	16	8
BCF-225	Φ225 x 88	Single	230	50/60	0.57	129	2600	1070	79	4	26	8
BCF-250	Φ252 x 84	Single	230	50/60	0.83/1.13	190/250	2550/2750	1540/1660	74/76	6	26	8
BCF-355	Φ355 x 174	Single	230	50	1.12	245	1400	2800	74	4	15	2
BCF-400	Φ400 x 185	Single	230	50	1.6	370	1370	3653	77	6	13	1

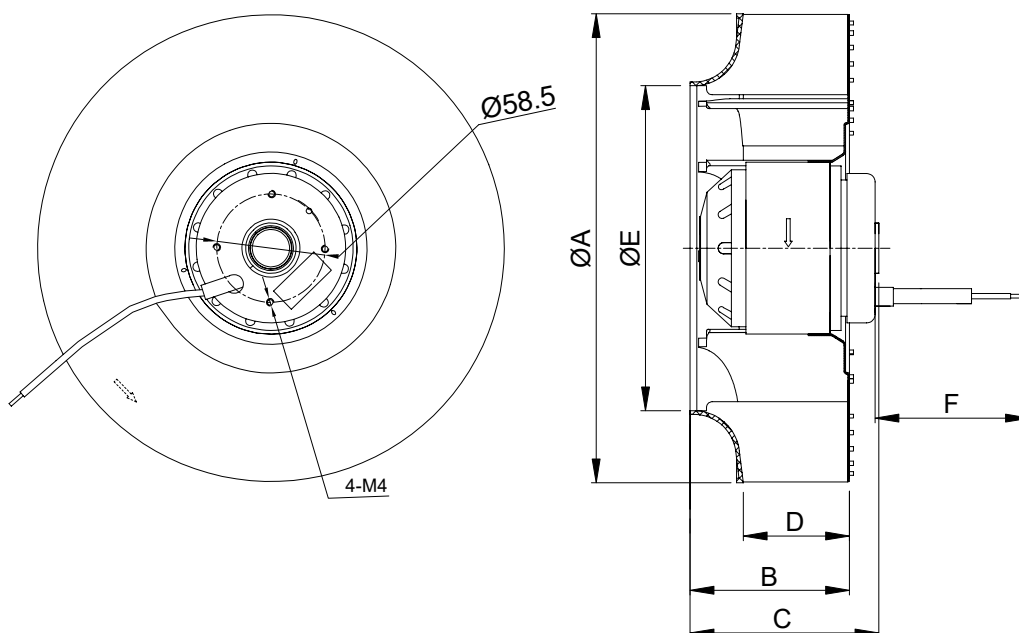

Dimensions (mm)

Model	A	B	C	D	E	F
BCF-133	133	59.5	77.5	42	93	600
BCF-175	180	61.5	71	45	131	1000
BCF-190	192	63	68	45	130	1100
BCF-220	220	63	72	45	159	1100
BCF-225	225	88	104	63	155	500
BCF-250	252	84.3	102	56	172	900

Note:

- Few sizes available in 3 Phase.

Specifications subject to change without notice



Corporate Headquarters

Hicool Electronic Industries

Plot No. A-104, TTC Industrial Area, MIDC,
Khairne, Navi Mumbai - 400 710,
Maharashtra, India.

Tel: +91 86575 52651

Email: sales@hicoolfans.com

Basecamp

Manufacturing Facility

Gut No. 36/1 & 37, Near Talegaon MIDC,
Jadhavwadi, Pune - 410 507, India.

